

# Baumit MonoPlus

## With StarContact base coat installation guidelines



### STAGE 1: BEADING

1. All beading work should be completed a minimum of 24 hours prior to the application of Baumit MonoPlus.
2. Using Baumit StarContact White, bed the beads on to the substrate and make level. Do not use Baumit MonoPlus to adhere the beads to the walls.
3. All other adhesive types such as Grip Fill, Pink Grip, Tile Adhesive etc. as well as metal fixings such as nails and staples are strictly prohibited for use within any Baumit render system.
4. Install PVC Corner Beads to all external corners, where required.
5. PVC Stop Beads must be used at all stop ends where required, such as soffits, window, and door frames, under sills, neighbouring properties, etc.
6. PVC Bellcast Beads must be used at the base of the render system to create an appropriate drip detail.
7. The Bellcast Bead must be set above the DPC line. Never bridge the DPC with Baumit MonoPlus. There must be a physical break in the render system along this line.
8. Do not finish Baumit MonoPlus down to the ground. There must be a minimum of 150mm between the ground and the base of the render system.
9. Once all the beading work is completed and all level, leave the StarContact White to cure for a minimum of 24 hours. If the contact mortar is still wet when applying the Baumit MonoPlus, there is a risk of knocking the beads out of level which will then impact the ability to achieve a flat, level finish.

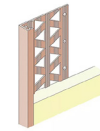

**Baumit PVC Stop Bead**  
15mm (2.5m)



**Baumit PVC Corner Bead**  
15mm (2.5m)

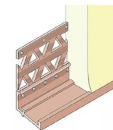

**Baumit PVC Bellcast / Drip Bead**  
15mm (2.5m)

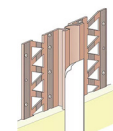

**Baumit PVC Movement Bead**  
15mm (2.5m)



#### Application site conditions:

Do not apply in temperatures below 5 °C. or above 30 °C.

Do not apply if frost is forecast within 24 hours from intended application.

Do not apply in wet or damp conditions.

Humidity levels should stay below 75% during the entire installation process. Humidity levels greater than 75% can greatly slow the curing process.

Ensure substrate temperature is above 5 °C and below 30 °C before application.

Do not apply in and protect the facade from direct sunlight, rain and strong winds (i.e. with scaffold nets).

In hot and/or windy weather dampen the finished work at regular intervals with a water mist sprayer to aid hydration.



#### Storage:

12 months from date of manufacture (on a pallet, in dry conditions and protected from weather)

# Baumit MonoPlus

With StarContact base coat installation guidelines



## STAGE 2: SUBSTRATE PREPARATION

- 1.** Mix the StarContact White with clean water in a large mixing bucket, to a wet, creamy consistency.
- 2.** The bonding mortar should be mixed with an electric hand mixer or a horizontal mixer for approximately 5 minutes.
- 3.** Leave the adhesive mortar to stand for five minutes and quickly mix through again with the hand mixer.
- 4.** The adhesive mortar remains workable for up to 1½ hours. Do not remix the bonding mortar later.
- 5.** The render is applied onto the substrate to an approximate thickness of 2mm using a stainless steel 10mm notched trowel.
- 6.** Immediately after applying the first coat of StarContact White, lay on sheets of StarTex Fine reinforcement mesh and smooth over, using a stainless-steel trowel to allow the contact mortar to pass through the mesh.
- 7.** Ensure the reinforcement mesh is free from creases.
- 8.** Each sheet of mesh must overlap by a minimum of 100mm. Never butt up the sheets of mesh.
- 9.** Install 250x250mm patches of mesh around all openings (e.g. Windows and Doors), 200mm wide strips of mesh into all internal corners and where applicable, into all window and door head areas within a reveal.
- 10.** Immediately after installing the mesh and whilst the first pass of basecoat is still wet, apply a final 2mm of StarContact White over the top of the mesh to fully embed it within the material.
- 11.** Leave a key in the StarContact White using a metal tooth comb, ready to receive Baumit MonoPlus.
- 12.** The drying times (1 day/mm thickness) must be observed.



Baumit StarContact White

# Baumit MonoPlus

## With StarContact base coat installation guidelines



### STAGE 3: APPLICATION OF BAUMIT MONOPLUS

- 1.** The substrate must be sound, stable, and free from frost, dust, dirt and separating agents. The areas to be rendered must be well keyed and evenly dry.
- 2.** To ensure colour consistency, complete elevations and adjoining panels should use bags all under the same batch number, or different batch stock be mixed prior to application.
- 3.** For machine application, spray onto the prepared wall surface using a 12mm or 14mm diameter mortar nozzle, to the required thickness of 10mm (First pass) and flatten off using a feather edge tool.
- 4.** Immediately after, lay on the Baumit StarTex Fine Mesh and smooth over, using a stainless-steel trowel to allow the MonoPlus to pass through the mesh.
- 5.** Each sheet of mesh must overlap by a minimum of 100mm. Never butt up the sheets of mesh.
- 6.** Install 250x250mm patches of mesh around all openings (e.g. Windows and Doors), 200mm wide strips of mesh into all internal corners and where applicable, into all window and door head areas within a reveal.
- 7.** Once all the reinforcement work is completed and the first pass of MonoPlus is still wet, apply a second coat to an approximate thickness of 8mm.
- 8.** Using a straight edge or smoothing trowel, level out immediately, ensuring the wall is flat and level.
- 9.** The total thickness should be 18mm.
- 10.** For thicknesses up to 28mm, applying in 2 passes wet on wet, allowing approximately 2 hours between passes.
- 11.** Allow to set (approx. 3-24 hours dependent on the substrate and drying conditions) before scratching the surface to give the desired final finish.
- 12.** Scratching should be undertaken when the render is almost set, but not hardened. Actual timing is dependent on the weather conditions and substrate.
- 13.** The surface is ready for scratching when a thumb impression cannot be made and when the render scrapes easily from the surface without sticking to the scratching tool.
- 14.** Scratching should be completed in a tight circular motion, and the surface brushed down with a soft brush upon completion.
- 15.** To ensure colour consistency, all surfaces should be scratch finished at the same stage of render readiness.
- 16.** Use a consistent application process to ensure an even finish.
- 17.** A minimum 15mm scratched finish should be achieved.
- 18.** When applied, the MonoPlus product is a darker shade than the intended finished colour. This will lighten over a number of weeks to the desired colour; the same colour as the dry product within the bag. This is normal for a cementitious product and which is to be an expected characteristic of MonoPlus. The speed of lightening to the desired colour is entirely dependent on finish, substrate, temperature, and humidity levels at the time of application.

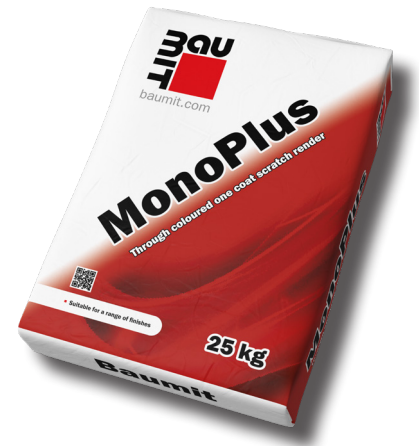

Baumit MonoPlus 25kg

For additional support:

01622 710 763

technical@baumit.co.uk